

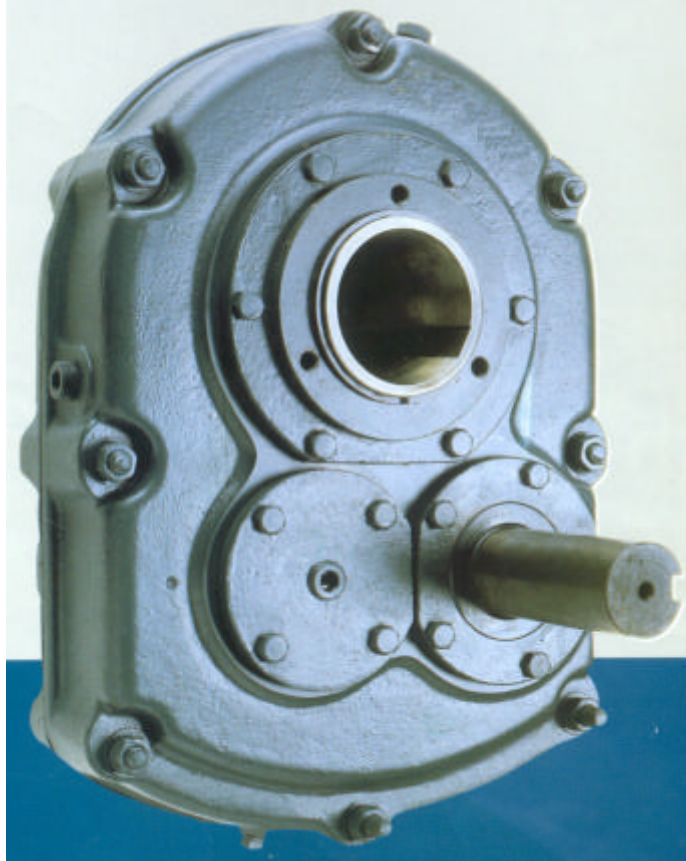

# Shaft Mount Reducers



**Design Features**

**Easy Installation**

Simply insert the shaft key and slide the inboard bushing, reducer and outboard bearing onto the input shaft of your device. Then position and tighten the bushing mounting screws to complete the installation.

**Easy Removal**

The torque arm screws double as jacking screws, so no puller is required. Just remove the bushing mounting screws and insert them into the tapered holes in the bushing flanges. Once tightened, the reducer should slide easily off of the shaft.

**Flexibility**

Mounting versatility enables these torque arm reducers to be positioned anywhere along the driven shaft in horizontal, vertical and inclined positions for greater installation ease.

**Heavy Duty Cast Housing**

The cast, corrosion resistant, ductile iron housings are precision machined. A ribbed housing construction provides strong, rigid support for bearings and gearing. This design also channels oil to all bearings for superior lubrication and extended operating life.

**Features**

Double lip seals retain oil while locking out dirt.

Helical gear tooth design maximizes the power transfer efficiency.

Twin taper bushings eliminate play between the reducer and shaft. No set screws to score, mar or gouge the shaft.

Twin tapered bushings make these reducers the optimal gearboxes for use on conveyors, mixers, and packing machinery.

The reducer mounts directly on the driven shaft, eliminating the need for a coupling or chain drive, sliding motor base, and support structure. There are no alignment problems.

**Available Sizes**

315  
325

415  
425

515  
525

615  
625

**Other Considerations**

*Low Price Guarantee*

*Minimal Lead Times*

*Off-the-shelf parts*

*Nationwide distribution*

*One Year Replacement Warranty*

[www.crushersales.com](http://www.crushersales.com)

**Cornerstone Equipment, Inc.**

13037 Ottawa Drive, Savage, MN 55378-1673

Tel: 952-894-4550 Fax: 952-894-1187



# Shaft Mount Reducers

## Speed Reducer and Motor Mount Dimensional Information

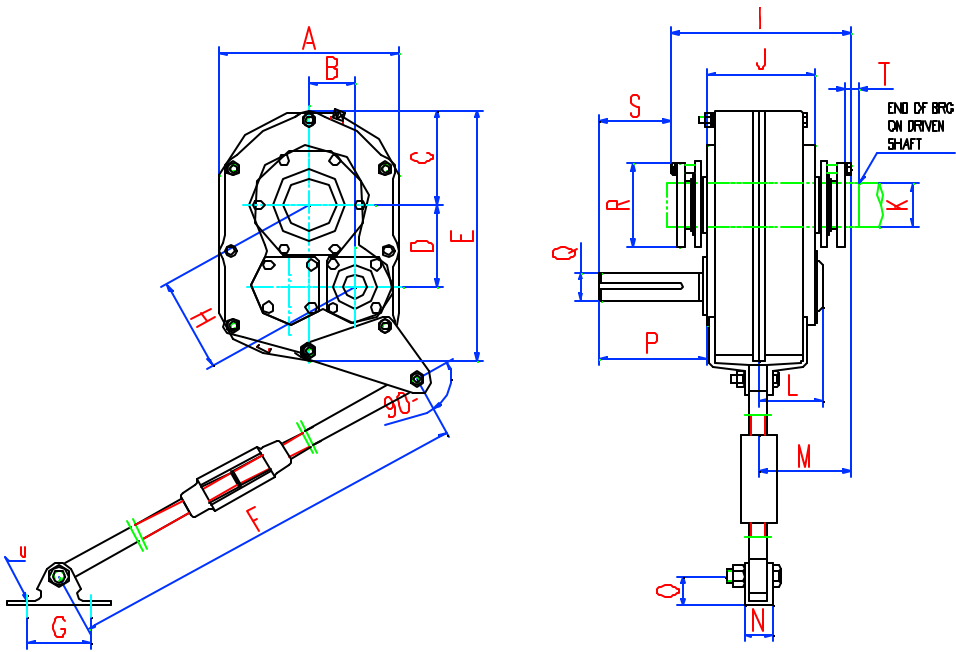

Reducer Dimensions				
	3	4	5	6
A	9.25	10.38	13.13	15.13
B	2.33	2.76	3.04	4.09
C	4.84	5.50	6.56	7.56
D	4.17	4.79	5.67	6.73
E	12.88	15.13	18.31	21.31
F	26.94-32.94	29.19-35.19	29.19-35.19	29.19-35.19
G	3.00	4.00	4.00	4.75
H	4.78	5.53	6.43	7.88
I	9.22	9.98	10.52	11.53
J	5.63	6.13	6.31	6.88
K	2 3/16	2 7/16	2 15/16	3 7/16
L	3.30	3.14	4.45	4.57
M	4.52	4.79	5.05	5.73
N	1.25	1.44	1.44	2.75
O	1.06	1.75	1.75	2.00
P	4.34	5.57	5.74	6.08
R	4.38	4.81	5.63	6.13
S	2.34	3.44	3.44	3.73
T	1.50	1.75	1.81	1.81
U	0.44	0.50	0.50	0.63

<b>Size 3</b>	1.25 Diameter Shaft; .25 x .13 x 2.88 Keyed Shaft
<b>Size 4</b>	1.44 Diameter Shaft; .38 x .19 x 4.06 Keyed Shaft
<b>Size 5</b>	1.94 Diameter Shaft; .50 x .25 x 4.50 Keyed Shaft
<b>Size 6</b>	2.19 Diameter Shaft; .50 x .25 x 4.50 Keyed Shaft

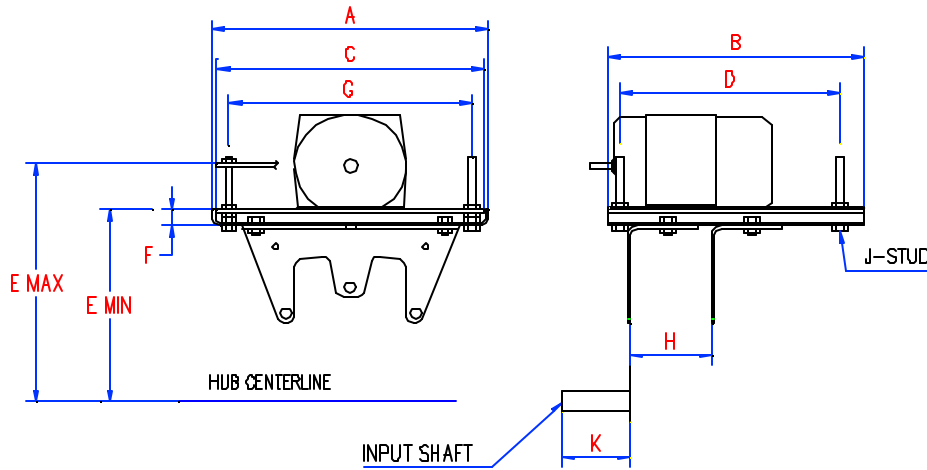

Motor Mount Dimensions				
	3	4	5	6
A	14.63	18.63	18.63	20.50
B	11.00	17.00	17.00	18.50
C	13.50	17.50	17.50	19.25
D	9.25	14.25	14.25	16.50
E	11.59-15.78	11.96-16.73	12.53-17.28	14.56-19.31
F	1.62	1.78	1.84	1.84
G	12.00	15.50	15.50	17.50
H	4.25	4.63	4.13	4.50
J	5/8 x 7	3/4 x 8	3/4 x 8	3/4 x 8
K	4.88	6.13	6.65	7.31

Standard Bushing Kits					
	1-15/16	2-3/16	2-7/16	2-15/16	3-7/16
<b>Size 3</b>	X	X			
<b>Size 4</b>		X	X		
<b>Size 5</b>			X	X	
<b>Size 6</b>				X	X